



www.crollababy.com



NEX 360

CHILD RESTRAINT SYSTEM INSTRUCTION

Group: 0+/1/II/III

Weight: 0-36 KG



TO DEAR USER

Congratulations on becoming part of the Crolla family!
We are so excited to be part of your journey with your little one. While traveling with the Crolla Nex 360 child restraint you are using a high quality, fully certified safety Group 0+/1/2/3 child restraint. Please carefully read this manual and follow each step to ensure a comfortable ride and best protection for your child. If vehicle is equipped with ISOFIX, the vehicle lower anchor points may be visible at the vehicle seat crease. See your vehicle owner's manual for exact locations, anchor identification, and requirements for use.

Please read all the instructions in this manual before installing and using the product.

KEEP FOR FUTURE REFERENCE. PLEASE READ CAREFULLY. Please keep the instruction manual in the properly.

For warranty information, please visit our website at www.crollababy.com

▲ IMPORTANT

DO NOT use forward facing before the child's weight exceeds 9KG.

▲ IMPORTANT

DO NOT use the product in seating positions where an active frontal airbag installed.

- For used rearward facing as Group 0+/I

This child restraint is classified for “(Restricted/Semi-universal)” use and is suitable for fixing into the seat positions of the following cars:

Motorcycle type	Front seats	Rear seats	
		Outside	Intermediate
Passat 2017 1.8T 330TSI	NO	YES	NO
Corolla 2017 1.6L CVT GL	NO	YES	NO
Audi A4L 2019 2.0 TFSI	NO	YES	NO

*Seat positions in other cars may also be suitable to accept this child restraint. If in doubt, consult either the child restraint manufacturer or the retailer.

- For used as Group 0+ /I

1. This is an ISOFIX CHILD RESTRAINT SYSTEM. It is approved to Regulation No.44,04 series of amendments for general use in vehicles fitted with ISOFIX anchorages systems.

2. It will fit vehicles with positions approved as ISOFIX positions(as detailed in the vehicle handbook), depending on the category of the child seat and of the fixture.

3. The mass group and the ISOFIX size class for which this device is intended is Group 0+ /I(0-18KG)D;Group I(9-18KG)B1.

- For used forward facing as Group I/II/III

1.This is a “Universal” child restraint; it is complied with Regulation No.44,04 series of amendments, for general use in vehicles and it will fit most car seats.

2.A correct fit is likely if the vehicle manufacturer has declared in the vehicle handbook that the vehicle is capable of accepting a “Universal” child restraint for this age group.

3.This child restraint has been classified as “Universal” under more stringent conditions than those which applied to earlier designs which do not carry this notice.

4. If in doubt, consult either the child restraint manufacturer or retailer.

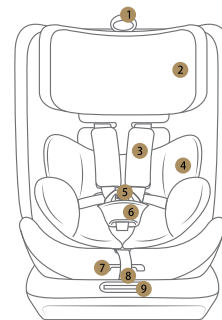

- 1 Handle of headrest
- 2 Headrest
- 3 Chest pad
- 4 Comfortable cushion
- 5 Buckle

- 6 Crotch pad
- 7 Body Angle adjuster
- 8 Harness adjuster strap
- 9 Rotation adjuster
- 10 Base
- 11 ISOFIX release button
- 12 ISOFIX attachment



01

PRODUCT OVERVIEW

02

SAFETY WARNING

- NO child restraint can guarantee full protection from injury in an accident.
- However, proper use of this child restraint will reduce the risk of serious injury or death to your child.
- The child should weigh under 36kg (approximately 12 years old).
- Make sure that the straps holding the restraint to the vehicle should be tight and any straps restraining the child should be adjusted to the child's body. Check to make sure that the straps are not twisted.
- DO NOT use forward facing mode before the child's weight exceeds 9kg. Keep your child rearward facing as long as possible as rearward facing is the safest position.
- DO NOT install or use this child restraint without following the instructions and warnings in this manual or you may put your child at serious risk of injury or death.
- DO NOT make any modifications to this child restraint or use it along with component parts from other manufacturers.
- DO NOT use this child restraint if it is damaged or has missing parts.
- DO NOT have your child in swaddled clothes when using this child restraint in rear facing or forward facing mode, because this may prevent your child from being properly and securely fastened by the shoulder harnesses and the harnesses between thighs.
- When using this child restraint in rear facing or forward facing mode, the harness must be used correctly, and make sure the lap belt is not above the child's pelvis portion.

- DO NOT leave this child restraint unsecured in your vehicle because an unsecured child restraint can be thrown around and may injure occupants in a sharp turn, sudden stop, or collision. Remove it if not in regular use.
- NEVER leave your child unattended with this child restraint.
- Please do not use this child restraint if the child restraint has dropped from a significant height, hit the ground at a considerable speed, or has visible signs of damage. We are not responsible to replace if the child restraint has been damaged under these abnormal conditions. A new child restraint will need to be purchased when any of the aforementioned conditions occurs.
- NEVER install this child restraint on any vehicle seat equipped with safety airbags when used in rear facing mode.
- NEVER use a second-hand child restraint or a child restraint whose history you do not know because they may have structural damage that endangers your child's safety.
- Please keep this child restraint away from sunlight, otherwise it may be too hot for the child's skin.
- DO NOT use this child restraint as a regular chair as it tends to fall down and could injure the child.
- DO NOT use this child restraint without the soft goods.
- DO NOT put anything other than the recommended soft goods in this child restraint.
- DO NOT put unsecured items in the vehicle because they can be thrown around and may injure occupants in a sharp turn, sudden stop, or collision.
- Do not place other items on top of the child restraint if it is in the car boot to prevent damage.
- Do not allow the child restraint harness or buckles to become trapped or caught in the vehicle seat or door.
- DO NOT continue to use this child restraint after it has suffered any violent crash. Replace immediately as there may be invisible structural damage from the crash.
- Remove this child restraint from the vehicle seat when it is not in use for a long period of time.
- To avoid suffocation, remove plastic bag and packaging materials before using this product. The plastic bag and packaging materials should then be kept away from babies and children.
- Consult the retailer for issues concerning maintenance, repair and part replacement.
- DO NOT carry this child restraint with a child in it.
- Frequently check the ISOFIX guides for dirt and clean them if necessary. Reliability can be effected by ingress of dirt, dust, food particles etc.
- Correct Installation is only permitted by use of the ISOFIX connectors.

03

USAGE

3.1 Install position of the child seat in vehicle

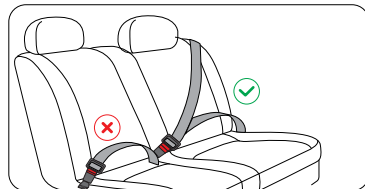

- Only suitable if the approved vehicles are fitted with 3 point safety-belt, approved to UN/ECE Regulation No.16 or other equivalent standards.

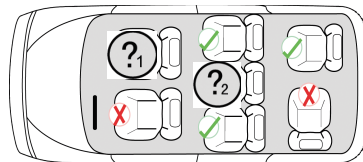

- ① Not to use rearward-facing in seating positions where an active frontal airbag is installed.
- ② Only use on this seat if ISOFIX anchorages are fitted.

3.2 Adjust the headrest

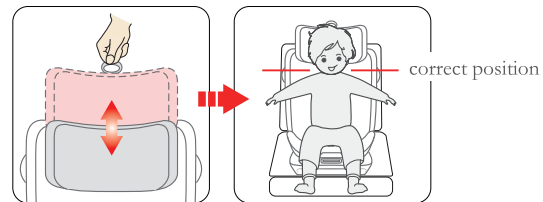

Picture 1

- As shown in picture 1, pull the adjusting ring to adjust the headrest up and down, and hold it to the correct position. The headrest has 8 gears which can be adjusted up or down according to the child's height.

3.3 Checking the shoulder strap height

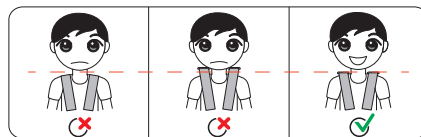

- Always check that the shoulder straps are at the correct height for your child. The child's shoulder straps should always be threaded through the slots in the cover and seat shell that are closest to the top of your child's shoulders.

3.4 Usage of buckle

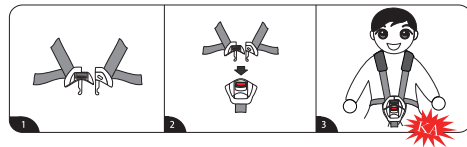

buckle (sketch map)

Steps to buckle the harness

- Step 1. Put the two metal sections of the buckle connector together.
- Step 2. Engage the buckle connector until it clicks
- Step 3. Check the harness is correctly locked by pulling the shoulder straps upwards.

To release the harness, you can press the red button of the buckle downwards, the two metal sections will be pop up.

3.5 Adjust the length of harness

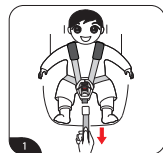

Picture 1

- Picture1:Tighten the harness.
Pull the harness upward to remove the slack from the lap sections of the harness then pull the front stretch belt until the harness is fully tightened. The harness should be adjusted as tightly as possible without causing discomfort to your child. A loose harness can be dangerous. Check the harness adjuster and tighten each time when the child is placed in the seat.

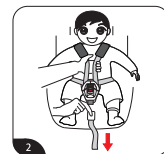

Picture 2

- Picture 2:Loosen the harness.
The harness can be slacked by pressing the adjuster(under the seat cover)on the front of the seat. Press down the adjuster as you grip the two harness with your another hand.Pull the harness towards you to loosen the harness.

3.6 The method to remove the shoulder straps

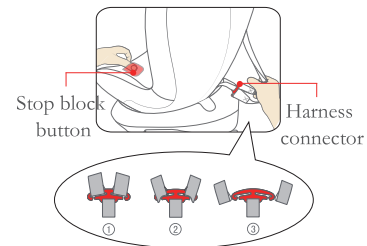

- Press and hold the stop block button at the front of the seat, and at the same time pull out the harness connector with shoulder strap on the back of the seat;
- Loosen the shoulder harness turn the child restraint system to the back.
- Slide the chest straps and shoulder straps off the harness connectors.(As shown in figure ①②③)

3.7 Adjust the ISOFIX attachments

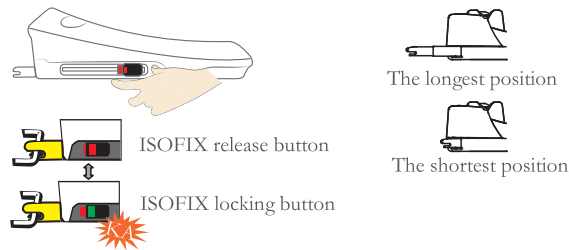

- The ISOFIX attachments can be adjusted for many positions to fit the different positions of ISOFIX low anchorages extending from car seat. Press down the release button to adjust ISOFIX attachment of both sides to the longest. Then put the ISOFIX attachments into guide sleeves, and insert them into ISOFIX anchorages. Make sure that you have heard a “click” sound and the ISOFIX indicator turns GREEN. Then push the child restraint forward until it is tight against the car seat. To release ISOFIX, press the red button, and pull the ISOFIX back to the shortest position.

3.8 Adjust the child seat to different incline position

3.8.1 Rearward-facing Group 0+ / I to adjustment

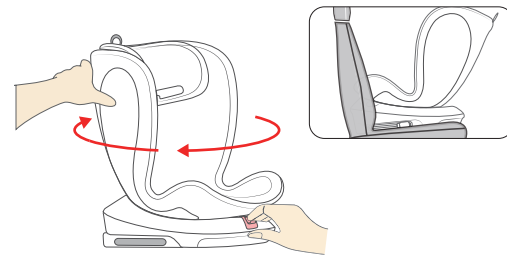

- Adjust to the fourth gear, (see page 10, 3.8.2), then hold the rotary button with one hand (left side of the picture) and turn the child restraint system with the other hand; the child restraint system is adjusted to position 5 or 6.

3.8.2 Forward-facing Group I / II / III to adjustment



- Pull the angle adjuster (Picture left)
- Adjust the gears up and down. There are 4 gears that can be adjusted.
Gears for forward-facing: ①②③④

3.9 Usage of the top tether

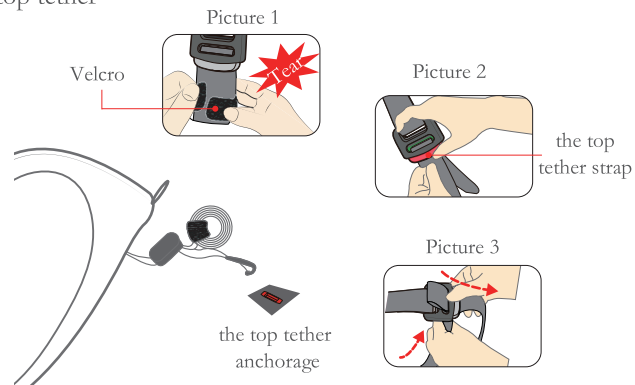

- Firstly, tear the storage Velcro (see Figure 1);
- Secondly, press and hold the button of the top tether adjuster (see Figure 2) and release the top tether to the appropriate length (Figure 3);
- Next, hang the top tether connector to the the top tether anchorage which recommended in the vehicle user manual;
- Finally, tighten the top teather until the adjustment indicator shows green.

4.1 Installation of rearward-facing using ISOFIX + the top tether (Group 0+/I, Weight 0-18KG)

⚠ IMPORTANT: Do not use forward facing before the child's weight exceeds 9KG.



- Step 1: Turn the child restraint system to the position facing the vehicle door, and then install the child restraint system to the vehicle seat with ISOFIX. Attached ISOFIX to the ISOFIX anchorage system (see page 9, 3.7), and hear a "click" sound, the ISOFIX indicator will turn into GREEN.

04 INSTALLATION



- Step 2: Place the child on the child restraint system and insert buckle into the slot. As you hear a "click" sound, check whether the buckle is locked. (See page 7, 3.4)



- Step 3: Rotate the seat to the opposite direction as shown in picture;

- Step 4:
Method 1: Take the top tether strap out (see page 11, 3.9), go through two sides of seat, engage the top tether hook to the designated position of your car seat.

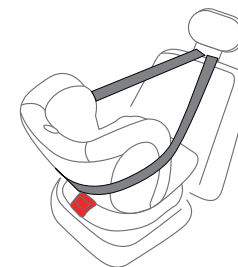
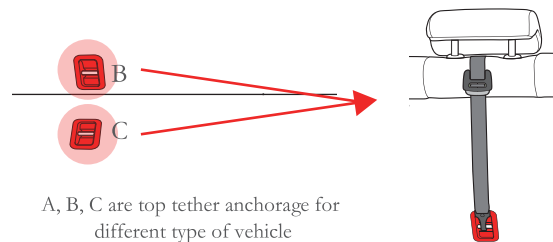
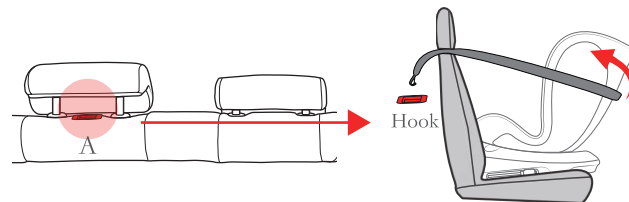

Sketch map

Method 2: Take the top tether strap out (see page 11, 3.9), go through one side of seat, engage the top tether hook to the designated position of your car seat.

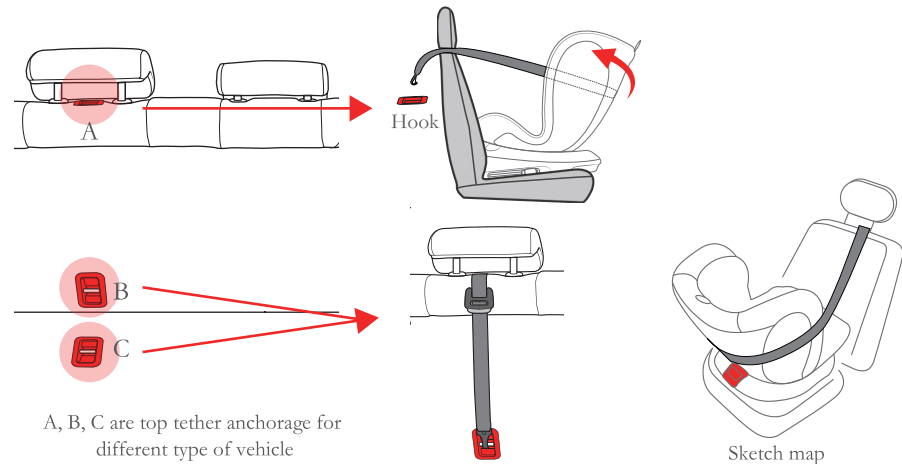

4.2 Installation of forward-facing using ISOFIX + the top tether (Group I, Weight 9-18KG)

▲ IMPORTANT: Please remove the Triangle sponge.

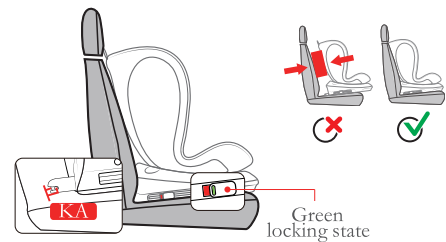

- Step 1: Put the child restraint system on the car seat, make it close to the car seat. Fixing ISOFIX to the ISOFIX attachment (see page 9, 3.7) until hearing the "click" sound, and the ISOFIX indicator will turn green;

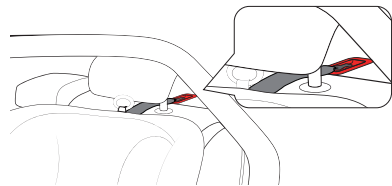

- Step 2: Engage the top tether hook to the designated top tether anchorage of your car .
Note: Tighten the top tether strap until the color of the top tether strap adjuster turns green.

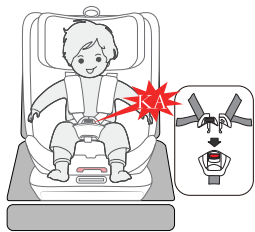

- Step 3: Place the child on the child restraint system, and then secure the child with a five-point safety belt (see page 6, 3.3 and 3.4).

4.3 There are two types of installation method during forward-facing installation (Group: II / III, suitable for weight 15-36KG)

! IMPORTANT: Please remove the cushion , Triangle sponge crotch pad , buckle, chest pad and the shoulder straps.



For " semi-universal" category child restraint, fixed with FIX + adult three-point seat belt.

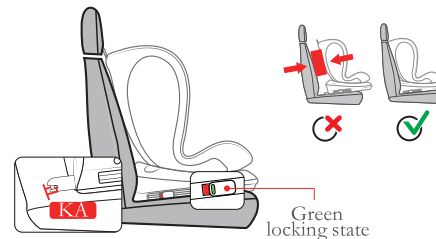

- Step 1: Put the child restraint system on the car seat, make it close to the car seat. Fixing ISOFIX to the ISOFIX attachment (see page 9, 3.7) until hearing the "click" sound, and the ISOFIX indicator will turn green;

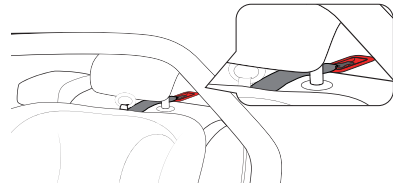

- Step 2: Engage the top tether hook to the designated top tether anchorage of your car.
Note: Tighten the top tether strap until the color of the top tether strap adjuster turns green.

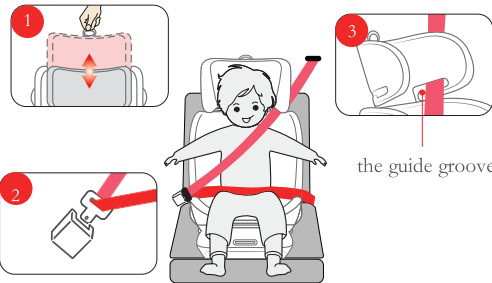

- Step 3: Place the child on the child restraint system.
- Adjust the headrest height to ensure that the headrest is at the child's shoulder level and fixed well;
- According to the installation path shown on the left, insert the car seat belt into the car groove of the car seat and then buckle it up ;
- Make sure that the car seat belt strap passes through the guide groove of the headrest ;
- Make sure the car seat belt is not slack or twisted.

For " universal" category child restraint, fixed with adult three-point seat belt.



- Step 1: Put the child restraint system on the car seat.

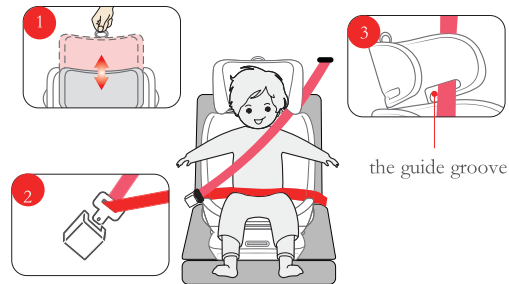

- Step 3: Place the child on the child restraint system.
- Adjust the headrest height to ensure that the headrest is at the child's shoulder level and fixed well;
- According to the installation path shown on the left, insert the car seat belt into the car groove of the car seat and then buckle it up ;
- Make sure that the car seat belt strap passes through the guide groove of the headrest ;
- Make sure the car seat belt is not slack or twisted.

05

MAINTENANCE AND CLEANING

5.1 Daily maintenance

- In daily use, check periodically the child seat. The child seat should be replaced after an accident.
- Please keep this child seat in dry and ventilated place to avoid damp moldy.
- If the child seat becomes dusty, clean the seat belt and the plastic pieces by swiping them with a damp sponge and let it dry under ambience.
- If food or drink drop accidentally on the buckle, disassemble the seat belt from the child seat and rinse it gently by warm water. Leave it dry under ambience .
- For cleaning the entire child seat fabric cover, please refer to the 5.2 washing instruction.

5.2 Washing instruction

- Never use any solvent, chemical detergent or lubricant on any part of your child seat.



Hand wash, water
temperature
below 30 °C



Do not bleach



Dry clean, any
solvent except
trichloroethylene.



Do not tumble dry



Do not iron

5.3 Remove and assemble the fabric cover

- First remove the cushion, chest and crotch pad. (see 3.6).
- Remove buckle of the base and remove the cover of headrest, base and backrest.
- To assemble the fabric cover of the child seat, repeat the above prescribed procedure in reverse order.

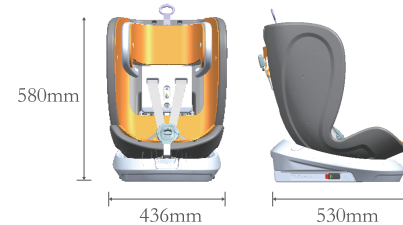

- Distance from front to back of the seat: 530mm
- Distance from left to right of the seat: 436mm
- Height of the seat: 580mm
- Weight of the seat: 12.1 ± 0.5kg

06

THE MAIN TECHNICAL PARAMETERS