

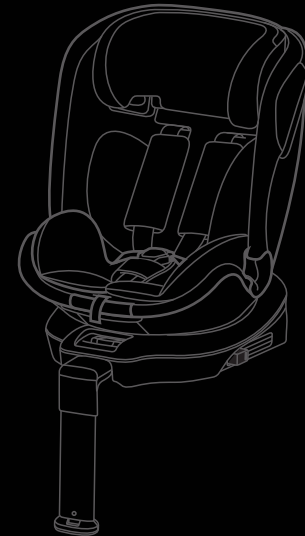

CROLLA i-Size 360

ENHANCED CHILD RESTRAINT MANUAL INSTRUCTION



Register warranty at www.crollababy.com



TESTED & APPROVED
ECE-R129
Economic Commission for Europe

Follow us at



Crolla Malaysia



Crollababy

TO DEAR USER

- Congratulations on your purchase of **Crolla i-Size 360**. Please read this manual carefully before using this Crolla enhanced child restraint system (ECRS) for your child's comfort and safety.
- If you have any questions concerning the use of **i-Size 360**, please do not hesitate to contact us.

▲ IMPORTANT

DO NOT use the child restraint in front seat due to the airbag installed in the vehicle.

▲ IMPORTANT

DO NOT use forward facing before the child's age exceeds 15 months.

This Crolla i-Size ECRS is approved according to ECE R129/03 Regulation

For the usage of this enhanced child restraint, your child must meet the stated criteria below.

- **For Rear - Facing**

Child height: newborn - 105cm

- **For Forward - Facing**

Child height: 105cm - 135cm

Child age at least 15 months

- For warranty information, please visit our website at www.crollababy.com.

- Based on the product overview, please make sure there are no missing parts. Please do not hesitate to contact the retailer if anything is missing.

i-Size ECRS



Additional marking



01

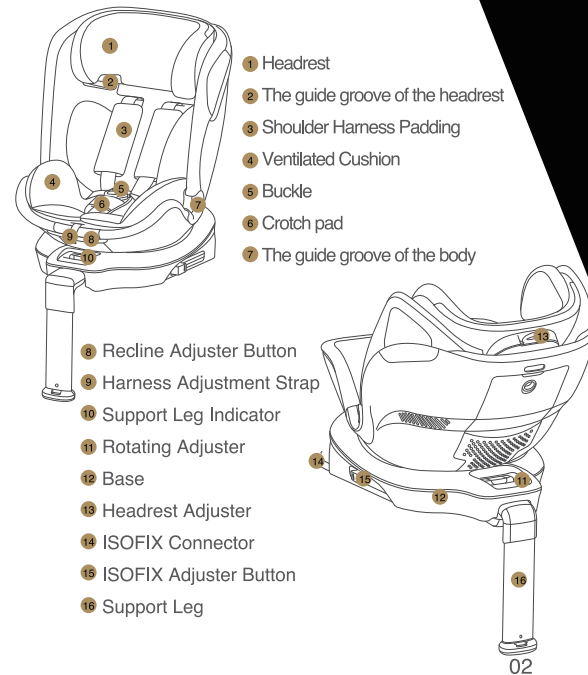

01

PRODUCT OVERVIEW

02

02

SAFETY WARNING

- To use this enhanced child restraint system with the **ISOFIX** connections according to the ECE R129/03 Regulation, your child must meet the following requirements.
Rearward Facing: Child height newborn - 105cm;
Forward Facing: Child height 105cm - 135cm/ Child age at least 15 months.
- **IMPORTANT - DO NOT USE FORWARD FACING BEFORE THE CHILD'S AGE EXCEEDS 15 months.**
- Any support leg should be in contact with the vehicle floor and any straps restraining the child should be adjusted to the child's body. The straps should not be twisted.
- After your child is placed in this enhanced child restraint system, the safety belt must be used correctly, and ensure that any lap strap is worn low down, so that the pelvis is firmly engaged, shall be stressed.
- This enhanced child restraint system should be replaced when it has been subject to violent stresses in an accident. An accident can cause damage to them that you cannot see.
- Concern the danger of making any alterations or additions to the device without the approval of the competent authority, and a danger of not following closely the installation instructions provided by the enhanced child restraint system manufacturer.
- Please keep this enhanced child restraint system away from sunlight, otherwise it may be too hot for child's skin. Always touch the enhanced child restraint before placing child in it.
- Please make sure child is not left in the enhanced child restraint system unattended.
- Any luggage or other objects liable to cause injuries in the event of a collision shall be properly secured.
- The enhanced child restraint shall not be used without the soft goods.
- The soft goods should not be replaced with any other than the one recommended by the manufacturer, because the soft goods constitute an integral part of the restraint performance.
- **DO NOT** use any load bearing contact points other than those described in the instructions and marked on the enhanced child restraint system.
- **NEVER** install this enhanced child restraint system on any vehicle seat equipped with safety airbags when used with rear facing mode.
- Please check before you purchase this enhanced child restraint system to make sure it can be installed properly in your vehicle.
- **NO** enhanced child restraint system can guarantee full protection from injury in an accident. However, proper use of this enhanced child restraint system will reduce the risk of serious injury or death to your child.
- **DO NOT** install this enhanced child restraint system without following the instructions in this manual or you may put your child at serious risk of injury or death.
- **DO NOT** use this enhanced child restraint system if it has damaged or missing parts.
- **DO NOT** have your child in large/oversized clothes because this may prevent your child from being properly and securely fastened by the shoulder harness straps and the crotch strap between the legs.
- **DO NOT** leave this enhanced child restraint system or other items unbelted or unsecured in your vehicle because an unsecured enhanced child restraint can be thrown around and may injure occupants in a sharp turn, sudden stop, or collision.
- **NEVER** use a second-hand enhanced child restraint system or an enhanced child restraint system whose history you do not know because it may have structural damage that compromises your child's safety.
- **NEVER** use ropes or any other substitutes to secure enhanced child restraint system in vehicle or to secure child into enhanced child restraint.
- Be sure that the enhanced child restraint system is installed in such a way that no part of it interferes with movable seats or in the operation of vehicle doors.
- Consult the distributor for issues concerning maintenance, repair and part replacement.
- Remove this enhanced child restraint system from the vehicle seat when it is not in use for a long period of time.
- The parts of this enhanced child restraint system should not be lubricated in any way.
- Always secure child in enhanced child restraint system, even on short trips, as this is when most accidents occur.
- Frequently check the **ISOFIX** guides for dirt and clean them if necessary. Reliability can be affected by ingress of dirt, dust, food particles etc.
- **DO NOT** put anything other than the recommended inner cushions in this enhanced child restraint system.

03

USAGE

3.1 Installing the enhanced child restraint system

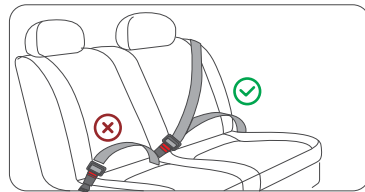

- Only suitable for vehicles that are fitted with 3 points safety belt, according to the ECE Regulations No.16 or other equivalent standards.

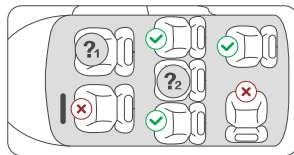

- ?₁ Please do not use rear-facing when the enhanced chair restraint system is installed in a seat position where an active airbag is installed.
- ?₂ Only use the enhanced chair restraint system when the ISOFIX connectors is firmly fitted to the seat.

05

3.2 Adjusting the headrest

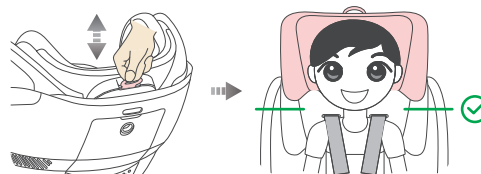

Picture 1

- As shown in picture 1, pull the adjusting ring to adjust the level of the headrest according to your child's height. When your child is seated, please recheck if the side of the headrest is at your child's shoulder level.

3.3 Checking the shoulder strap position



- Please adjust the head support and check if the shoulder harnesses are at the proper height when your child is seated.

- **In rear-facing position**, the shoulder harness height must be even with or below the top of child's shoulders.
- **In forward-facing position**, the shoulder harness height must be even with the top of child's shoulders.

06

3.4 Engaging the buckle

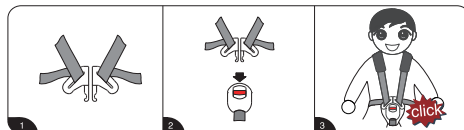

buckle (sketch map)

Step 1: Get the left and the right buckle tongues together.

Step 2: Connect the two buckle tongues, then insert into the slot of the buckle and you will hear a “click” sound. It means that the buckle is secured.

**If you want to unbuckle, you need to press the red button on the buckle.*

3.5 Adjusting the harness



Picture 1

- **Picture 1: Tighten the harness**

Pull down the harness adjustment webbing and adjust it to the proper length to make sure your child is properly secured. Always keep child secured in harness and properly tightened by removing any slack.

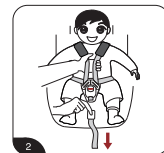

Picture 2

- The harness can be slackened by pressing the adjuster (under the seat cover) on the front of seat. Press down the adjuster as you grip the harness strap with another hand, Pull the harness towards you to loosen the harness. Only pull the harness strap, not the shoulder pads.

3.6 Detachable and removable goods

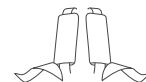

shoulder pads and the shoulder straps



crotch pad



buckle (sketch map)

When the child's height is between 105cm - 135cm, please remove the above items for your child's safety.

3.7 Storing shoulder straps, shoulder pads and buckle

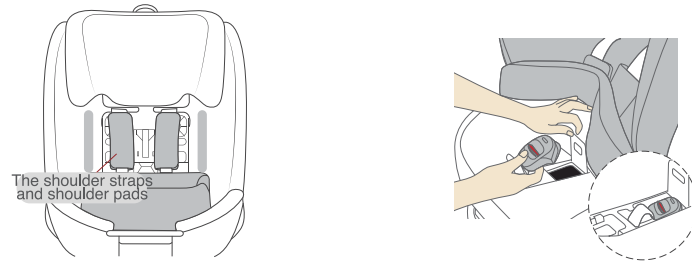

Step 1: Remove the fabric of the enhanced child restraint system.

Step 2: Store the shoulder straps and pads in the storage slot. Tighten the harness adjustment strap properly and then cover the fabric of the enhanced child restraint system.

Step 3: Lift up the fabric of the enhanced child restraint system, and put the disassembled buckle to storage slot.

3.8 Adjusting the ISOFIX connectors



- Press the ISOFIX adjuster button and push it all out to the longest.
- Then, put the ISOFIX connectors and insert them into the ISOFIX anchor. The ISOFIX connectors must be attached and locked onto the ISOFIX anchor points.
- After successfully installing the ISOFIX connectors, push the enhanced child restraint system forwards until it comes in contact with the vehicle seat tightly.
- Make sure that you can hear a “click” sound and the ISOFIX indicator is green, which indicates the enhanced child restraint system is installed properly.

3.9 Adjusting the support leg

When the child height is 40-105cm, you will need to use the support leg.

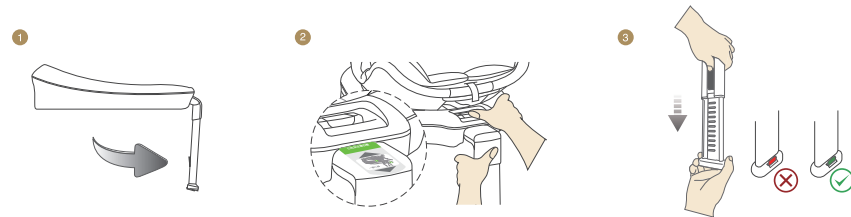

- 1 Pull the support leg downward to floor from the lower cover of the base.
- 2 Press and hold the support leg lock button. While holding the lock button, pull it out so that it is fixed to the correct position.
- 3 Press and hold the support leg adjustment button, then you can adjust the length of the support leg until it reaches the car ground. The indicator near the bottom of support leg will turn green when it is installed correctly.

When the child height is 105cm - 135cm, if you want to put away the support leg, you can press and hold the support leg adjustment button to adjust the length. Then, press and hold the support leg lock button, push it back to the original position. Lastly, push the support leg back to the lower cover of the base.

3.10 Rotating the seat

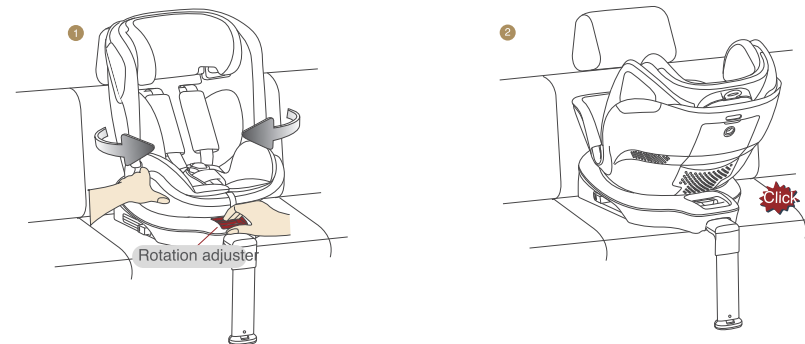

- 1 Pull the rotation adjuster handle with one hand and rotate the enhanced child restraint system with the other hand, both left and right directions can be rotated.
- 2 When you hear a "click" sound, it is indicated that the gear is in place.



When the child height is between 40-83cm, the enhanced child restraint system should be installed in rear-facing position.
When the child height is between 83-105cm, the enhanced child restraint system could be installed in either forward-facing or rear-facing position.
When the child height is between 105-135cm, the enhanced child restraint system should be installed in forward-facing position.

3.11 Adjusting the reclining system

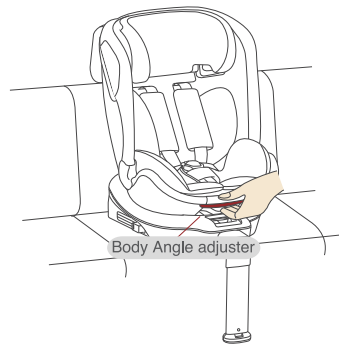

- 1 Pull the angle adjuster to adjust the reclining angle of the enhanced child restraint system.

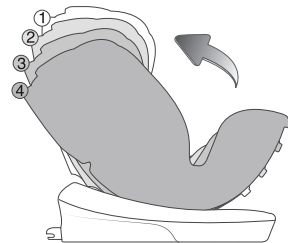

- Upright gear - 1st gear
- Recline gear - 2nd gear
- Recline gear - 3rd gear
- Recline gear - 4th gear

- 2 There is total 8 recline positions; 4 recline positions for rear facing mode and 4 recline positions for forward facing mode.

4.1 Installing the rear facing position



Child height : newborn - 105cm
Usage : ISOFIX & Support Leg



DO NOT use forward facing before the child's age exceeds 15 months.

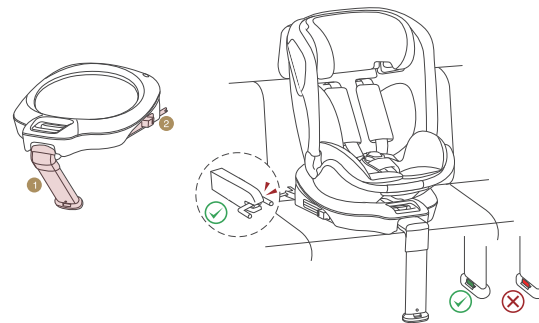

- 1 Pull the support leg from the lower cover of the base (see 3.9);
- 2 Push the ISOFIX connectors until the longest by using the ISOFIX adjuster (see 3.8);
- 3 Install the enhanced child restraint system on the car seat;

04 INSTALLATION



- 4 Rotate the seat to make it face the car door, then put your child in the enhanced child restraint system, adjust the shoulder straps and engage the buckle (see 3.3 ~ 3.5);

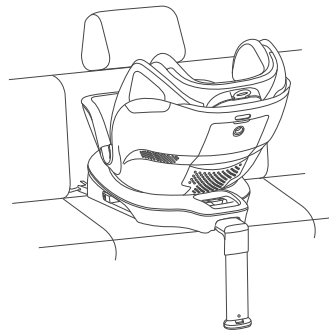

- 5 Lastly, rotate the seat to rear-facing position.

4.2 Installing the forward facing position

Child height : 83cm - 105cm

Usage : ISOFIX & Support Leg

PLEASE MAKE SURE YOUR CHILD EXCEEDS 15 MONTHS TO USE FORWARD FACING POSITION.

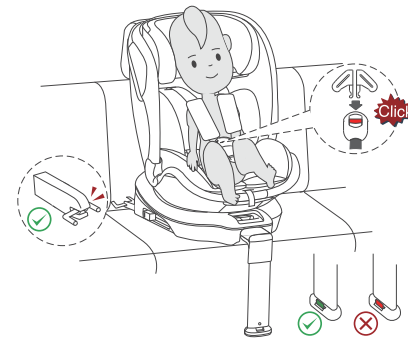

- 1 Pull the support leg from the lower cover of the base (see 3.9);
- 2 Push the ISOFIX connectors until the longest by using the ISOFIX adjuster (see 3.8);
- 3 Install the enhanced child restraint system on the car seat;
- 4 Lastly, put your child in the enhanced child restraint system, adjust the shoulder straps and engage the buckle (see 3.3 ~ 3.5).

4.3 Installing the forward facing position

Child height : 105cm - 135cm

Usage 1 : ISOFIX, adult three-point seat belt & support leg.

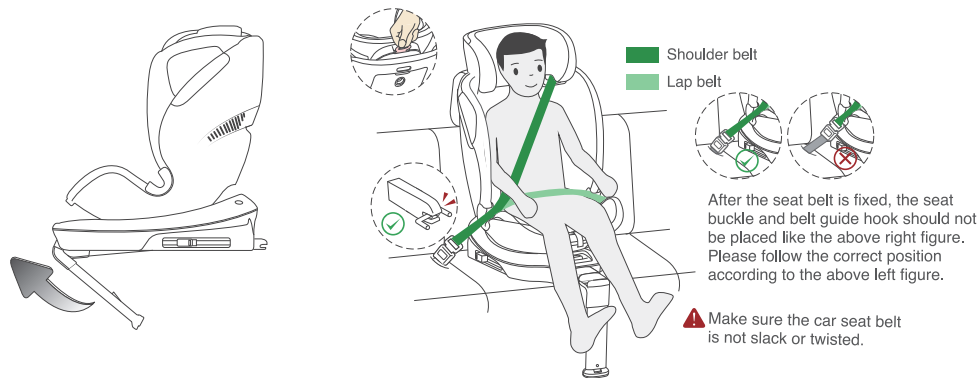

- 1 Pull out the support leg from the lower cover of the base (see 3.9);
- 2 Push the ISOFIX connectors until the longest by using the ISOFIX adjuster (see 3.8);
- 3 Install the enhanced child restraint system on the car seat;
- 4 Put your child in the enhanced child restraint system. Adjust the headrest height according to the child's shoulder height (see 3.2) ;
- 5 According to the installation path, pull the car seat belt across the child's body and passes into the car groove of the enhanced child restraint body part; Make sure that the car seat shoulder belt passes through the guide groove of the headrest, and pull the car seat lap belt to check whether it is locked.

17

Child height : 105cm - 135cm

Usage 2: Adult three-point seat belt.

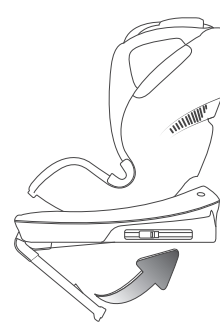

- 1 Put away the support leg (see 3.9)
- 2 Put your child in the enhanced child restraint system. Adjust the headrest height according to the child's shoulder height (see 3.2) ;
- 3 According to the installation path, pull the car seat belt across the child's body and passes into the car groove of the enhanced child restraint body part; Make sure that the car seat shoulder belt passes through the guide groove of the headrest, and pull the car seat lap belt to check whether it is locked.

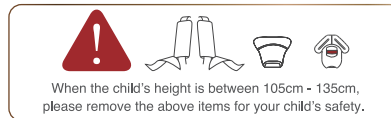
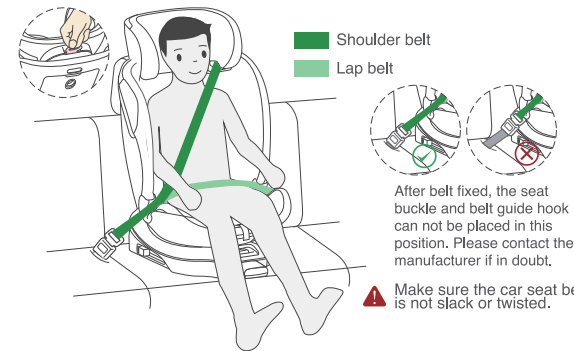

18

05

MAINTENANCE AND CLEANING

5.1 Daily maintenance

- In daily use, check the enhanced child restraint periodically. The enhanced child restraint should be replaced if there is an accident.
- Please keep this enhanced child restraint system in dry and ventilated place .
- If the enhanced child restraint system becomes dusty, clean the seat belt and the buckle tongues by swiping them with a damp sponge and let it dry naturally at place where your child cannot access it.
- If there is stain from food or drink on the buckle, disassemble the seat belt from the enhanced child restraint system and rinse it gently with warm water. Leave it dry naturally at place where your child cannot access it.
- For cleaning the enhanced child restraint system's fabric cover, please refer to the 5.2 washing instruction.

5.2 Washing instruction

- Never use any solvent, chemical detergent or lubricant on any part of the enhanced child restraint system.



Hand wash, water
temperature
below 30 °C



Do not bleach



Dry clean any
solvent except
trichloroethylene.



Do not tumble dry



Do not iron

5.3 Removing and assembling the fabric cover

- Remove the crotch pad and buckle of the enhanced child restraint system.
- Remove the headrest cover. Open the velcro (also known as hook and loop fastener) of the backrest cover, then remove the shoulder straps, cushion as well as the backrest cover.
- To assemble the fabric cover of the enhanced child restraint system , repeat the above prescribed procedures in reverse order.

06

THE MAIN TECHNICAL PARAMETERS

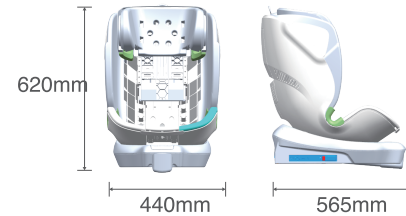

- Distance from front to back of the seat:565mm
- Distance form left to right of the seat:440mm
- Height of the seat:620mm
- Weight of the seat:11 ±0.5kg