



CROLLA *Flexxi*

APPROVAL ACCORDING TO EN 1888

START SOMETHING DISTINCTIVE

FOLLOW US AT



www.crollababy.com



Crolla Malaysia



Crollababy

WARNING:

Never leave your child unattended.

Ensure that all the locking devices are engaged before use.

To avoid injury, ensure that your child is kept away when unfolding and folding this product.

Do not let your child play with this product.

Always use the restraint system.

Check that the pram body or seat unit attachment devices are correctly engaged before use.

This product is not suitable for running or skating.

Lock the stroller when place and remove the children.

The max-loading weight for the basket is 5kg.

Any load attached to the handle and/or on the back of the backrest and/or on the sides of the stroller will affect the stability of the stroller.

Do not carry more than one child in this baby stroller.

Any extra accessories aren't allowed without the seller's permission, only use replacement parts supplied and approved by the manufacture.

This stroller does not replace a cot or a bed. Should your child need to sleep, then it should be placed in a suitable pram body, cot or bed.

Never use this product on a stand.

Use only on a firm, horizontal level dry surface.

- The stroller is suitable up to 22 kg or 5 years whichever comes first.
- The backrest reclined to the lowest position shall recommend when stroller is used by baby under 6months.
- Keep away this stroller from high temperatureobjects, liquids, and electronics.
- Please check if the components are installed in place and fastening before use it.
- Do not let the child climb out of the safety belts or stand on the seat.
- Do not use the stroller near the fire and other dangerous areas.
- Avoid to use or storage the stroller in wet, cold or high temperature environment, and keep it away from fire or strong heat.

Due to variation on the styles and designs of our products, the photographs and illustrations shown in this manual are generic.

Therefore products fabric, colour and design may vary from images shown, CROLLA reserves the right to alter products specifications.

PARTS LIST

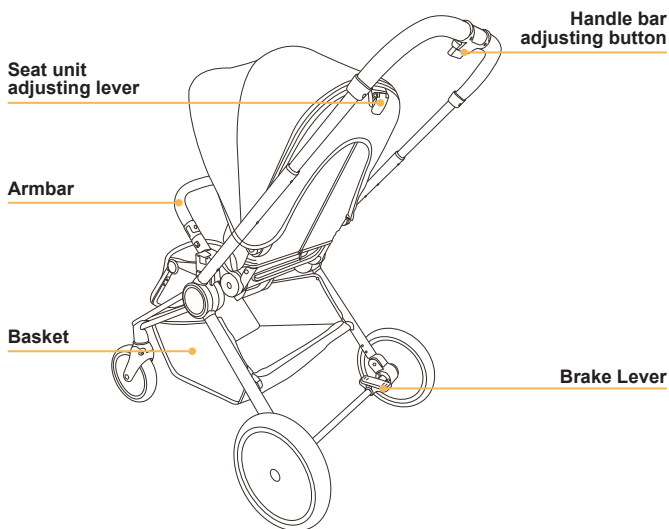
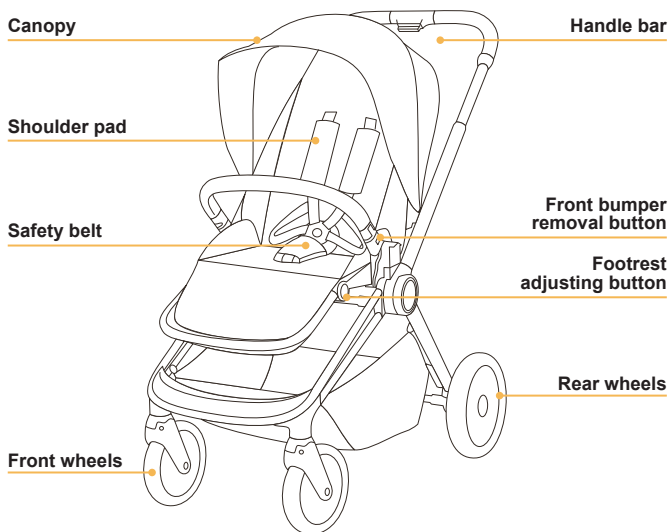

Accessory (sold separately)



1. **Adapter:** An adapter for a stroller to attach with a baby carrier is a device designed to allow a compatible baby carrier to be attached to a stroller.
2. **Baby carrier:** It's important to note that not all strollers are compatible with all baby carriers, so it's essential to check the manufacturer's instructions before using an adapter.

Accessory (included in the box)

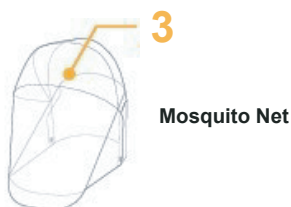

3. **Mosquito Net:** A mosquito net for a stroller is a protective barrier that is designed to keep mosquitoes and other insects away from a baby while in the stroller.

UNFOLDING THE STROLLER

1

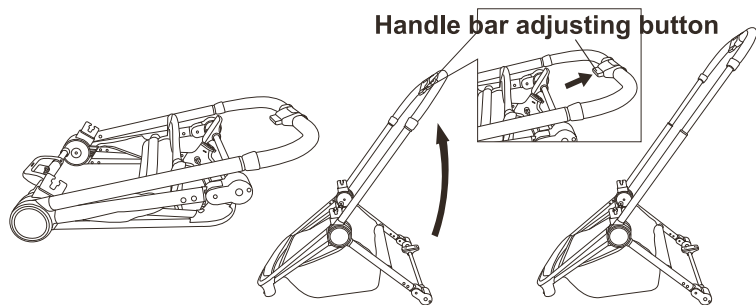

Lift the handle bar upwards until a “Click” sound, indicating the stroller is open completely.

Ensure the frame of the stroller is opened completely before use.

To adjust the height of the handle, pull the handle upward or downward while pressing the handle adjustment button.

ASSEMBLY THE WHEELS

2

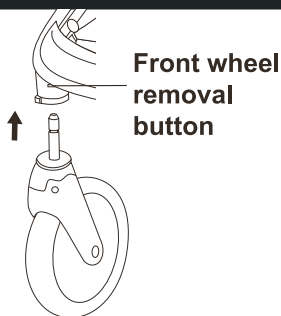

As the No. 2 picture shown, insert the front wheels into the front wheel bracket till the sound of “Click”, indicating it is assembled correctly. Same installing method on the other side. Ensure that the front wheels are securely attached. When disassembling, press the front wheels removal button, pulling the wheels outwards. Use the same method to disassemble the other side.

3

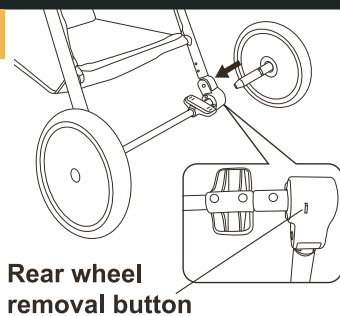

As the No. 3 picture shown, insert the rear wheels into the rear wheel bracket till the sound of “Click”, indicating it is assembled correctly. Same installing method on the other side. Ensure that the rear wheels are securely attached. When disassembling, press the rear wheels removal button, pulling the wheels outwards, same method to disassemble the other side.

INSTALLING THE ARMBAR

4

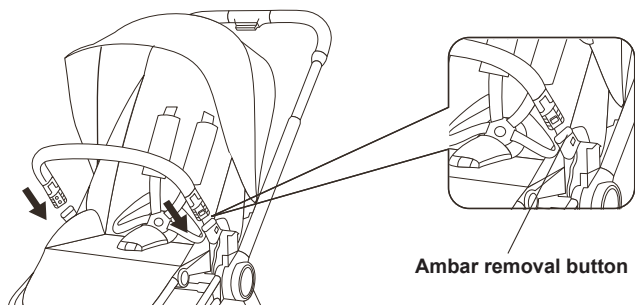

Inserting the armbar connector inside the socket of the bar till the sound of “click”. Indicating the correct installing way.

Pressing the both sides of removal button together, then can remove the armbar.

INSTALLING THE SEAT UNIT

5

Push the button on right side to remove seat + raiser from chassis

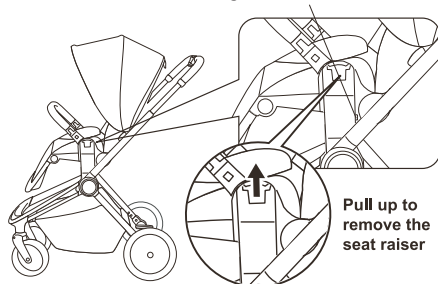

The seat unit can be installed by both two directions, forward and backward.

Squeeze the seat release buttons while lifting the seat. Turn the seat to reverse direction and then insert the seat unit to seat mounts. Till the sound of “click”. Indicating the correct installing way.

If the disassembling is necessary, pull up the release button on the left and right sides at the same time. Then can lift upwards the seat unit.

INSTRUCTIONS FOR USING THE SEAT BELT

1

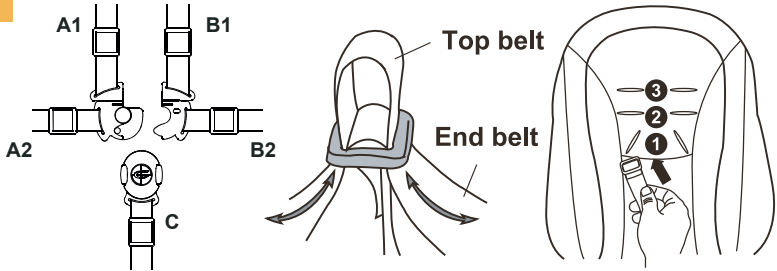

As shown in the picture, attach the A1 upper belt to the A2 lower belt, and attach the B1 upper belt to the B2 lower belt. Make sure that both Part A and Part B are locked, attach Part A and Part B together and attach to Part C.

Use the slide adjuster to change the harness length.

Always ensure the shoulder harnesses are at proper height. There are three levels height adjustment. To adjust the position of the shoulder harness anchor, thread it through the shoulder harness slot from back to front. Rethread it through the slot that is closest to child's shoulder height.

INSTRUCTION FOR USING THE STROLLER WHEELS

2

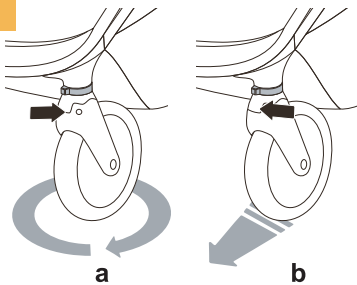

Push the front swivel locks to the left side, the wheel is in the state of free rotating as No. 2(a) picture shown.

Push the front swivel locks to the right side to maintain the moving direction as No. 2(b) picture shown.

Refer to No. 3 picture, to lock wheels, step the brake bar downwards. To release wheels, just lift the brake bar upwards.

3

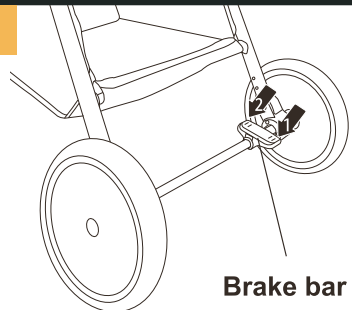

INSTRUCTION TO ADJUST THE BACKREST ANGLE

4

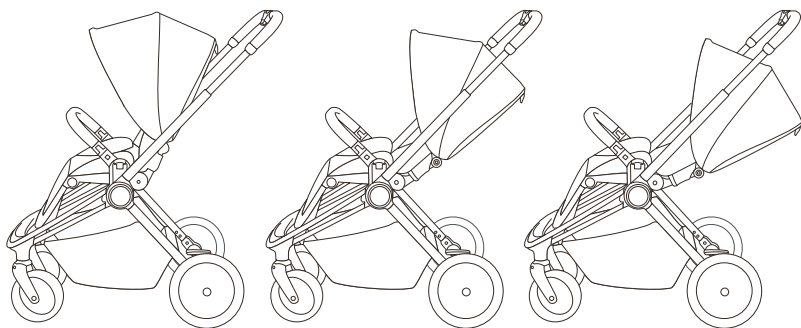
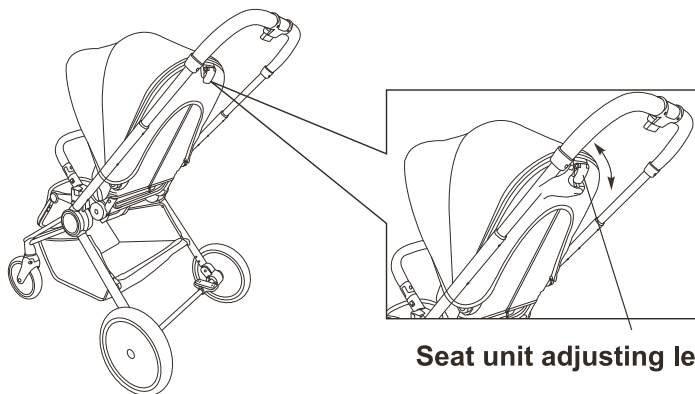

To recline the backrest, use the seat unit adjusting lever, and then adjust the backrest to a desired angle.

INSTRUCTION TO ADJUST THE HANDLE BAR

5

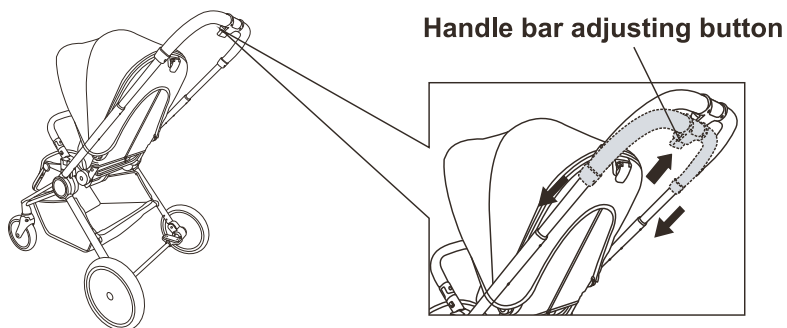

To adjust the height of the handle, pull the handle upward or downward while pressing the handle adjustment button

INSTRUCTION TO ADJUST THE FOOTREST

6

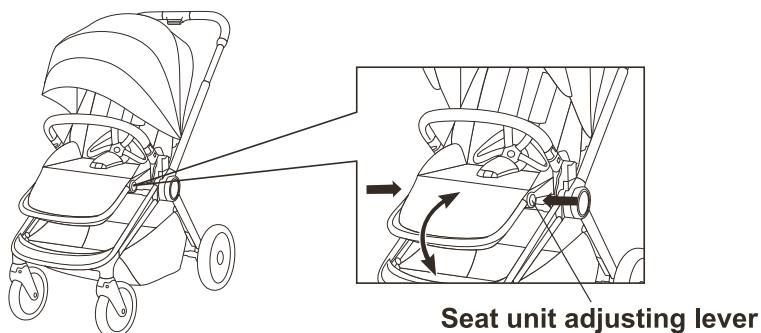

As the picture shown, pressing the footrest adjusting button on both sides (left and right) at the same time to adjust the footrest up and down.

INSTRUCTION FOR FORWARD FOLDING

1

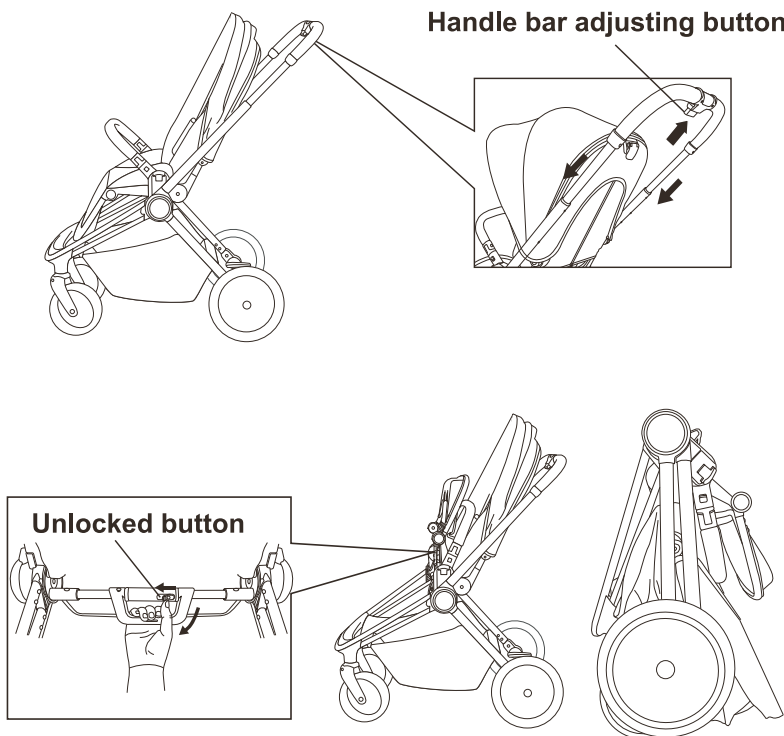

When the seat unit is used in the forward direction. To adjust the height of the handle, push the handle downward while pressing the handle adjustment button. Then, raise the footrest to the highest position.

Unlocking the button to the left with your thumb, holding the handle and lifting the stroller up at the same time. Then the stroller can be folded.

INSTRUCTION FOR REVERSE FOLDING

2

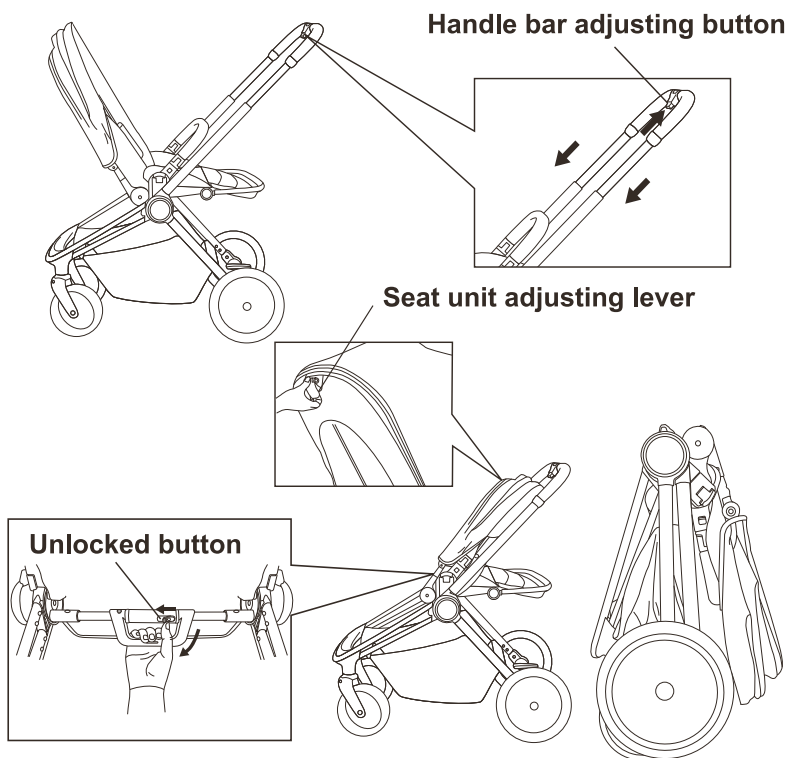

When the seat unit is used in the reverse direction. To adjust the height of the handle, push the handle downward while pressing the handle adjustment button. Then, adjusting the backrest level to the lowest position by moving it towards the front of the seat, closer to the handle bar.

Unlocking the button to the left with your thumb, holding the handle and lifting the stroller up at the same time. Then the stroller can be folded.

INSTRUCTION FOR USING HOOD

Open the zipper, then push the hood forwards to open the hood.

To fold the hood, pull hood toward back.

MAINTENANCE INSTRUCTION:

To ensure your baby is protected from accidental injury, please check and maintain the stroller regularly.

Please use brush cleaner to clean the seat fabric and use the household soap or neutral detergent to clean other parts.

Please do not store in direct sunlight and rain.

Regularly check if there is a screw loosening, parts damaged or structure broken, if necessary, replace the damaged parts.

Please use it according to the instruction manual carefully so as not to cause unnecessary damage.

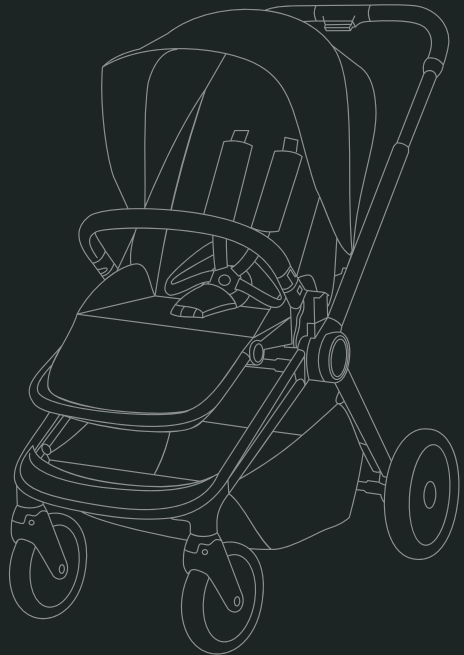

USE WITH CROLLA CARRIER

Baby carrier and adapters may be sold separately

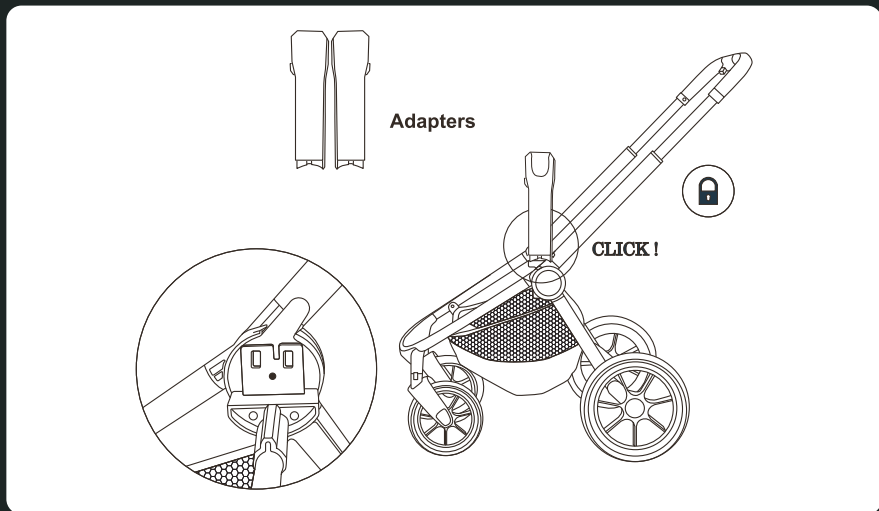

1a. Remove the seat unit from the frame to fit the adapters. To attach adapter, place the adapter onto mounts. Listen for a "click" sound indicating it is correctly assembled.

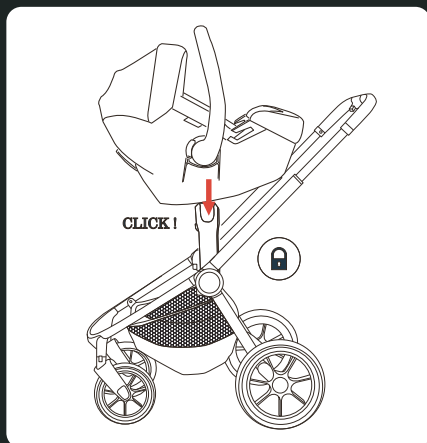

1b. To attach the baby carrier, place the baby carrier onto the adapters. Make sure the baby carrier is attached to the adapters properly.

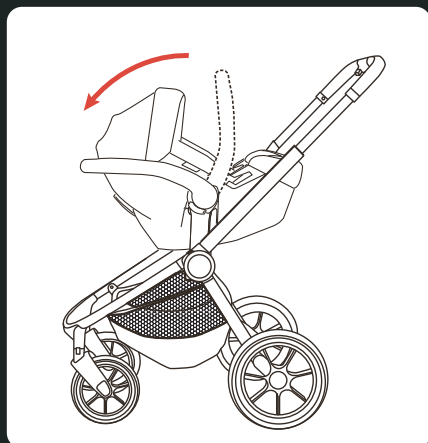

1c. Adjust the handle of the baby carrier by pressing the adjuster button at the side of the handle, moving down the handle as shown in the picture.

TO REMOVE THE BABY CARRIER

WARNING!

Never attach the car seat forward facing.

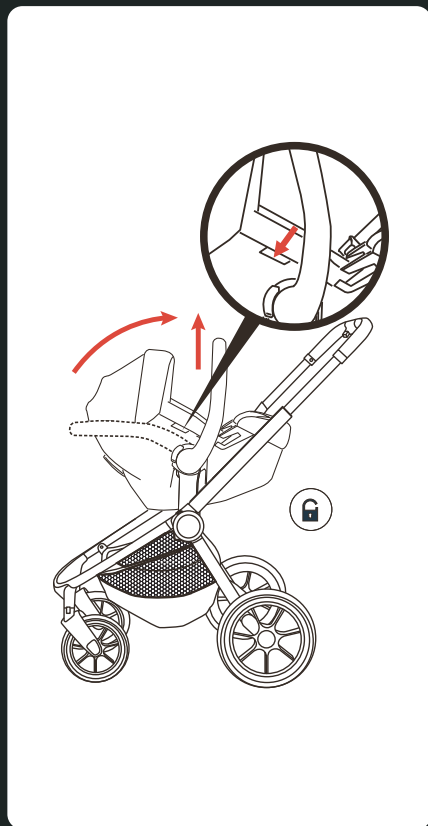

2a. Adjust the baby carrier handle to upright position by pressing the adjuster button at the side of the handle. Then, pull upwards to remove the baby carrier.

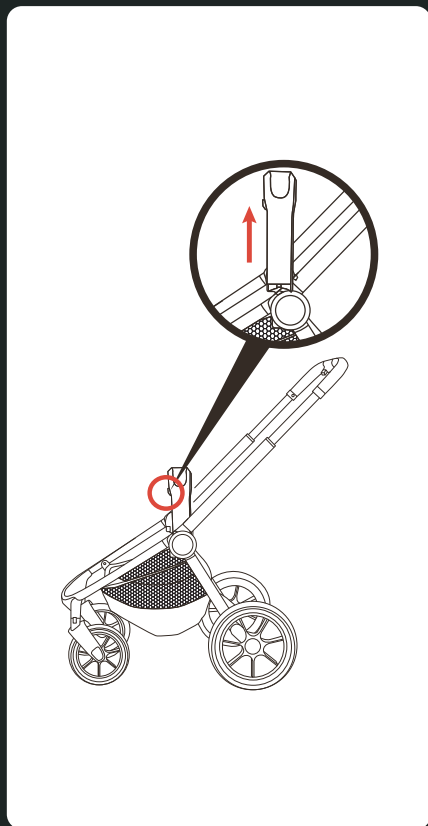

2b. To remove the adapter, by pressing the two release buttons. Remove the adapter as shown in the picture.