





**CROLLA | STELLA**

FOLLOW US AT

[www.crollababy.com](http://www.crollababy.com) 

Crolla Malaysia 

Crollababy 



# WARNING

- Read all instructions before assembly and use of the product. Keep the instructions for future reference.
- Please follow the warnings and instructions provided at the start of the manual.
- Always carefully read and adhere to the assembly instructions for each intended use mode of the product, including bedside sleeper, bassinet, and play yard.
- Failure to follow these warnings and the instructions could result in serious injury or death.
- To prevent falls, do not use of this product when the infant either starts pushing up on hands and knees or reaches a weight of 9 kg, whichever comes first.
- In the gaps between the additional padding and the sides of the bassinet, only use the pad provided by the manufacturer. Never add a pillow or other mattress for padding.
- To reduce SIDS risk, pediatricians advise placing healthy infants on their backs to sleep, unless instructed otherwise by a physician.
- Keep strings away from a child's neck and avoid using them over a bassinet, cradle, or with toys.
- Avoid using the bedside crib if any components are missing, damaged or broken.
- Do not replace any missing, damaged or broken components.
- This bassinet is intended for use only with adult beds measuring 22-27 inches (56-70cm) from floor to mattress top.
- Suitable for newborn to 9 kg (approximately 12 months old)
- Move your child to a different sleeping product once they reach 9 kg.
- To prevent the risk of an infant's neck getting caught on the top rail next to the adult bed, the top rail should not exceed the height of the adult bed mattress.
- Plastic bags may be dangerous. Please keep them out of children's reach to prevent suffocation hazards.
- Keep away from fire.

A bedside crib is designed to provide a sleeping area for an infant until he/she begins to push up on hands and knees. Move your child to another sleeping option once this happens.

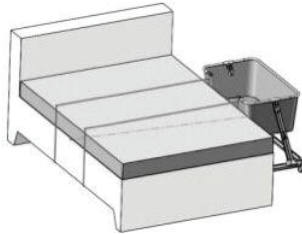

- This bed is suitable for co-sleeping mode due to aligned mattress, box springs and frame.
- Thus, there will be no gap between the side of bassinet and parent's bed.

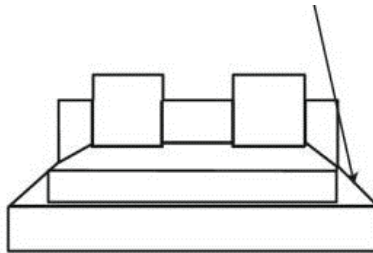

- This is not a suitable bed for co-sleeping mode due to the mattress, box springs and frame are not in line.
- Thus, there will be a gap between the side of bassinet and parent's bed.

# PARTS LIST

Before beginning assembly, please ensure that all the listed parts below are included in the box. Please do contact us if there are any missing parts.



A. Bassinet  
B. Mattress Pad  
C. Side Frame x 2

D. Bassinet Supports  
E. Support Bar  
F. Pillow

G. Toys x 2  
H. Mosquito Net  
I. Travel bag

# ASSEMBLY THE BASSINET

1



Attach both side frames (C) to the support bar (E) and secure them until its locked.

2



Place the bassinet (A) into the side frames (C) until they lock securely with a clicking sound.

3



Fit the bassinet bottom's support bar into the side frame until its locked.

4



WARNING: THE BASSINET SUPPORT (D) SHOULD NOT BE EXPOSED WHEN INSTALLED.

(i) Insert the bassinet support (D) into the bassinet cover.

(ii) Then, insert the bassinet support (D) into the locks underneath the bassinet until they are locked.

5

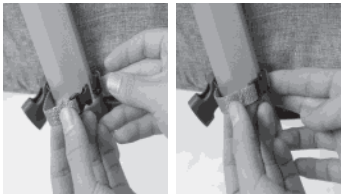

Fasten the left and right-side buckles of the bassinet.

6



Place the mattress pad into the bassinet with the padded side up. Pull the Velcro straps underneath the mattress pad and secure the mattress pad underneath the bassinet.

# ADJUSTING THE HEIGHT

The bassinet can be adjusted to 7 different height positions.

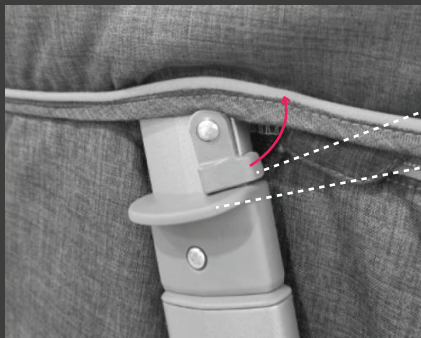

## To adjust the height:

1. Turn the safety lock.
2. Depress the handles on both sides and holding the safety lock at the same time.
3. Lift or lower the bassinet to the desired height.

## Tiltable Mode

The bassinet can be set with 2 different heights to make feeding more comfortable for the baby and in case of nasal congestion.



# SWITCHING TO BEDSIDE SLEEPER MODE

1

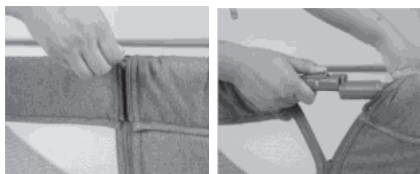

Unzip and slide the unlock button inward, then pull it upwards.

2

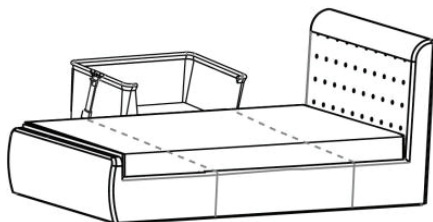

Fasten the connecting belt buckles around the frame or mattress of the adult bed.

3



Fasten the connecting belt buckles on the side of the bedside sleeper. Insert the connecting belt into the fixed straps on both sides of the bassinet. Fasten the buckles until they click and lock into place.



4

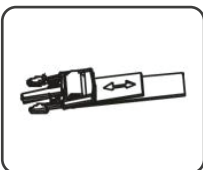
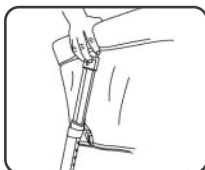

Adjust the height of the bassinet – as explained on page 6)  
Tighten the connecting belts.  
Ensure buckles are securely fastened before use.

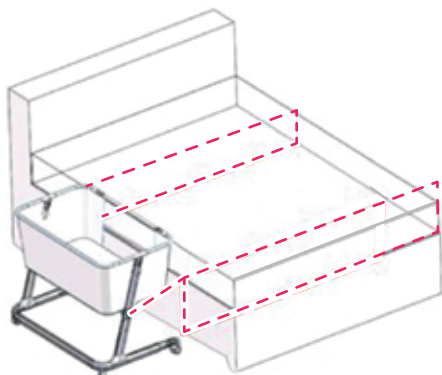

- To prevent entrapment and ensure safety, the bedside sleeper must be securely fastened to the adult bed using the attachment system.
- The gap between the bedside sleeper and the adult bed should not exceed 1/2 inch (13 mm). If gap exceeds 1/2 inch (13 mm), do not use this product.
- Never use pillows, blankets, or any other items that pose suffocation hazards to fill the gap.



**CO-SLEEP MODE (FIXING TO THE BED)**

- Always ensure that the child's head is positioned on the higher side.
- This function is exclusively designed for the bedside sleeper when it's in bassinet mode.



# CONNECTING WITH AN ADULT BED

1. Unlock the safety buckle, pass the connecting strap beneath the mattress, and reattach the safety buckle to secure the mattress tightly.

**Unlock the safety buckle:**



**Lock the safety buckle:**

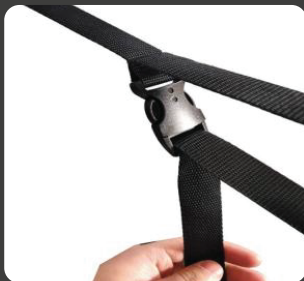

2. After securing the bassinet, gently push it to ensure that the space between the bassinet and the adult bed does not exceed 13 mm.

3. If it exceeds 13mm, please readjust the adjusting buckle on the connecting belt.

4. Please ensure that all four wheels of the bassinet are securely locked in place during use.

5. Before using the bassinet, neatly roll up and secure the excess connecting belt. Then, please check whether the connecting belt has been tightened.

6. When attaching the bassinet to the adult bed, ensure that the bassinet's lifting rail is in the lowest position and that its height is lower than the adult's bed to prevent any risk of baby falling out.

# LOCKING AND UNLOCKING THE WHEELS

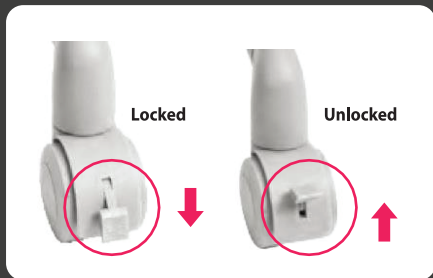

1. Push down the clip to lock the wheels.

2. Lift the clip upwards to unlock.

**WARNINGS: ALWAYS APPLY THE LOCK WHEN USING THE BASSINET.**

# CARE AND MAINTENANCE

- Prior to use, conduct an inspection and perform any necessary maintenance.
- Ensure that all necessary parts are used for each intended use mode.
- Regularly applying oil to rotating parts enhances the product's lifespan.
- Clean the bed using a soft, dry cloth or sponge; avoid using alkaline or acidic water on metal side frame or any other parts.
- To clean the mattress, the brush is allowed to use.
- Do not use or store it in prolonged exposure to damp, cold, or hot environments.
- When not in use, store it in a safe place and conduct regular inspections.