



CROLLA | NEX360 R129

APPROVAL ACCORDING TO ECE R129/03



FOLLOW US AT

 www.crollababy.com  Crolla Malaysia  Crollababy

PRODUCT OVERVIEW

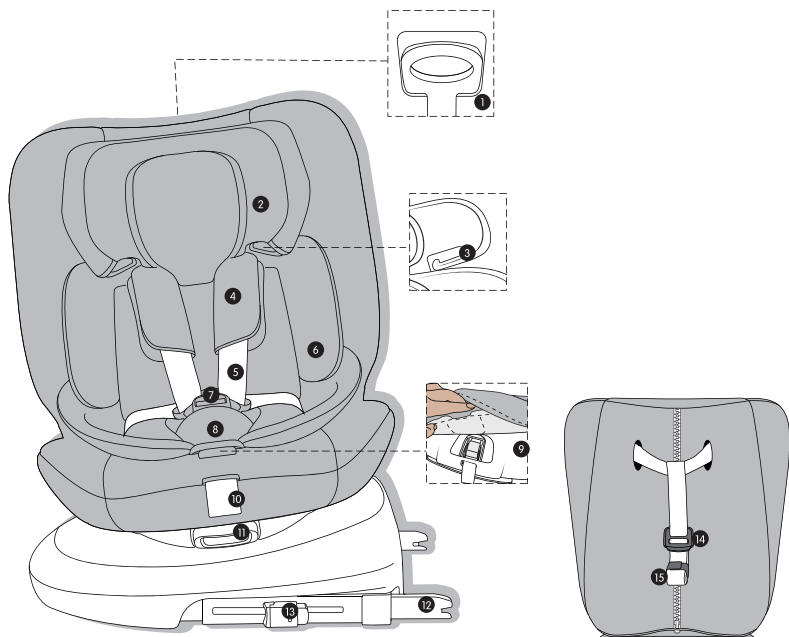

- ❶ Headrest adjustment lever
- ❷ Headrest
- ❸ Shoulder belt guide
- ❹ Shoulder pad
- ❺ Shoulder strap
- ❻ Infant insert
- ❼ Buckle
- ❽ Crotch pad
- ❾ Harness adjuster button
- ❿ Harness adjuster strap
- ⓫ Angle adjuster & Rotation adjuster
- ⓬ ISOFIX attachment
- ⓭ ISOFIX release button
- ⓮ Top tether release button
- ⓯ Top tether

NOTICE

I-SIZE ECRS NOTICE

This is an i-Size Enhanced Child Restraint System. It is approved according to UN Regulation No.129, for use in, i-Size compatible vehicle seating positions as indicated by vehicle manufacturers in the vehicle users' manual.

If in doubt, consult either the Enhanced Child Restraint System manufacturer or the retailer.

"I-SIZE BOOSTER SEAT" NOTICE

This is a i-Size booster seat Enhanced Child Restraint System. It is approved according to UN Regulation No. 129, for use primarily in "i - Size seating positions" as indicated by vehicle manufacturers in the vehicle user's manual.

If in doubt, consult either the Enhanced Child Restraint System manufacturer or the retailer.

- DO NOT use forward facing before the child's age exceeds 15 months.
- Do not to use the ECRS in seating positions where there is an active frontal airbag installed, death or serious injury may occur.



SAFETY WARNING

In order to ensure the safety of your child, please read the relevant instructions carefully to avoid dangerous situations!

UNDERSTAND THE PRODUCT

This is a height of 40-150cm product, suitable for children from 0-36KG.



40-105CM

Rearward-facing position **R-1234**



ISOFIX + Top tether
+ 5-point harness



76-105CM

Forward-facing position **F-1234**



ISOFIX + Top tether
+ 5-point harness



100-150CM

Forward-facing position **1**



ISOFIX
+ 3-point seat belt

*** DO NOT use forward facing before the child's age exceeds 15 months.**

PRECAUTIONS FOR PRODUCT USE

- This product can be rearward-facing used for children with a height of 40-105cm (Weight: 0-18kg), using ISOFIX +Top tether to fix the child restraint system;
- This product can also be forward-facing used by 5-point safety system for children with a height of 76-105cm (Weight: 9-18kg), using ISOFIX+Top tether to fix the child restraint system;
- This product can also be forward-facing used for children with a height of 100-150cm (Weight: 15-36kg), using adult three-point belt to fix the child restraint system, or using ISOFIX and adult three-point belt together to fix the child restraint system;
- Only use the contact points described in the instructions and marked in the child restraint between 100-150cm, avoiding any additional load-bearing points.
- Please keep for future reference, a storage compartment for the instructions is located on the back of the child seat.
- Do not use this child seat at home. It has not been designed for home use and should only be used in your car; Do not use rearward facing child seat in seating positions where there is an active frontal airbag installed, death or serious injury can occur;
- For the reason of safety, the child seat must be fixed inside the vehicle using ISOFIX anchorages even if you do not put your child inside the child seat;
- The rigid items and plastic parts of a child seat should be positioned and installed in a way that prevents them from getting caught in a moving seat or a vehicle door during everyday use;
- Any straps holding the restraint to the vehicle should be tight;

PRECAUTIONS FOR PRODUCT USE

- Any straps restraining the child should be adjusted to the child's body; Straps should not be twisted;
- Ensure that any lap strap is worn low down, engaging the pelvis firmly. This is crucial and should be emphasized; The device should be replaced if it has been subjected to violent stresses in an accident;
- It is dangerous to make any alterations to the child seat without the approval of the Type Approval Authority. It is also unsafe not to follow the installation instructions provided by the manufacturer:
- If the child seat does not have a cover, it should be kept away from direct sunlight to prevent it from becoming too hot for the child's skin;
- Don't leave your child in the child seat unattended;
- Any luggage or other object liable to cause injuries in the event of a collision shall be properly secured;
- The child seat shall not be used without the cover;
- The seat cover should not be replaced with any other than the one recommended by the manufacturer because the seat cover is a part of the child seat's performance;
- The instructions should be kept with the device throughout its lifespan;
- Never use a second-hand product, as you can never be certain what has happened to it;

3.1 INSTALL POSITION OF THE CHILD SEAT IN VEHICLE

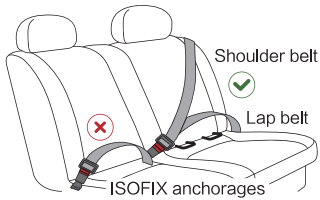

- ✓ Proper installation ✗ Improper installation

Only suitable for the approved vehicles that are fitted with 3 point safety belt which meet the safety standards UN/ECE Regulation No. 16 or other equivalent standards.

“ ” ISOFIX Anchor points for car seats

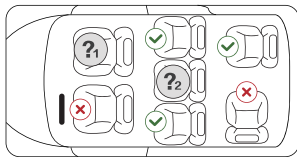

- ❓ Not to use in seating positions where an active frontal airbag is installed.
❓ Only use on this seat if ISOFIX anchorages are fitted

3.2 ADJUST THE HEADREST

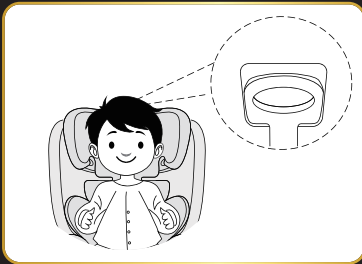

As shown in the picture, you can adjust the headrest up and down by pressing the headrest adjustment lever, to a position suitable for the child's head.

3.3 CHECKING THE SHOULDER STRAP HEIGHT



✗ too low



✗ too high



✓ at the shoulder level

Always to check that the shoulder straps are at the child's shoulder level.

3.4 USAGE OF BUCKLE

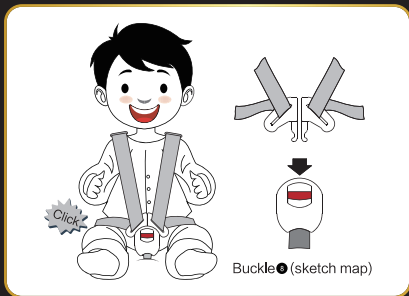

- Get the left and the right pieces of buckle together.
- Insert the two pieces into the slot of the buckle until hear a "click" sound, means it is buckled successfully.
- Check whether the harness is properly buckled by pulling the shoulder straps upwards.

- If you want to release the harness, you can press the red button of the buckle, the two pieces will pop up.

3.5 ADJUST THE LENGTH OF HARNESS

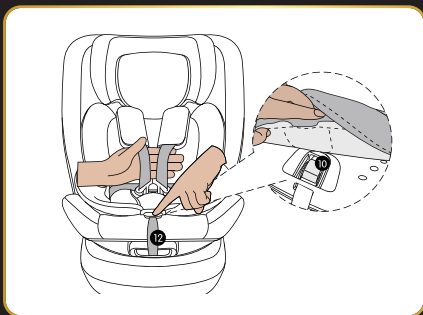

Loosen the harness

The harness can be slackened by pressing the harness adjuster button (10) on the front of the seat. Press down the button (10) as you grip the two shoulder straps with another hand. Pull the shoulder straps towards you to loosen the harness. When adjust the harness, do not press on the harness adjuster strap (12).

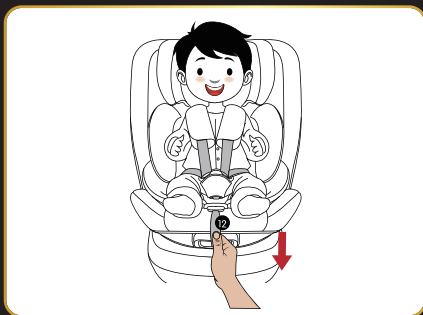

Tighten the harness

Pull the shoulder straps upwards to remove the slack from the lap sections of the harness. Then, pull the harness adjuster strap (12) until the harness is fully tightened.

* The harness should be adjusted as tightly as possible without causing discomfort to your child. A loose harness can be dangerous.

* Check the harness adjuster and tighten each time when the child is placed in the seat.

3.6 ADJUST THE ISOFIX ATTACHMENTS

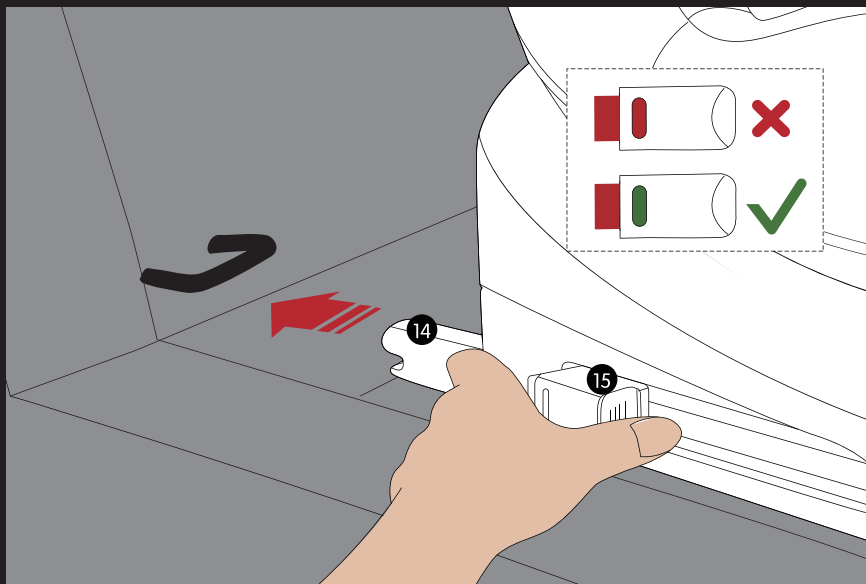

- The ISOFIX attachments can be adjusted to fit into the ISOFIX anchor points in the car.
- Press the release button to adjust both sides of the ISOFIX attachments to the longest then clip into the ISOFIX anchor points, until you hear a 'click' sound and make sure that the ISOFIX indicator turns to GREEN. Then, push the child seat forward until it is tight against the car seat.
- If you want to release the ISOFIX, press the release buttons on the both sides of the ISOFIX attachments, then pull the ISOFIX attachments back to the shortest position.



* Push the child seat until it is tight against the car seat.

3.7 ONE CLICK ADJUSTMENT METHOD: ROTATION & ADJUST GEAR

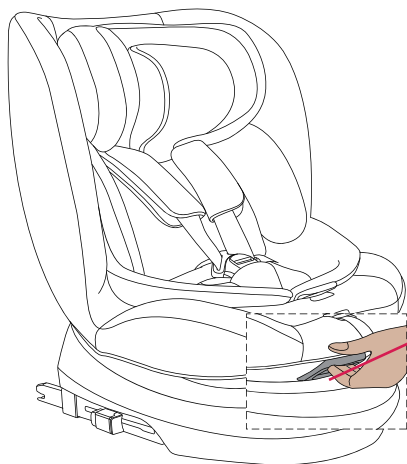

The angle adjuster and rotation adjuster share the same button.

Press the angle adjuster, then adjust back and forth to adjust the child seat to gear F1/F2/F3/F4.

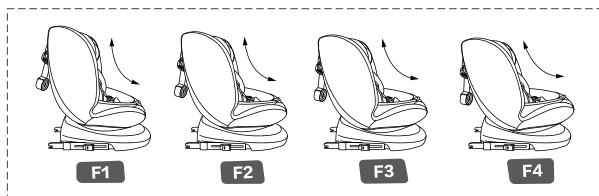

Press the rotation adjuster, then rotate the child seat left and right to adjust to rearward facing or forward facing. When the child seat is rearward facing it can also adjust to gear R1/R2/R3/R4 by pressing the angle adjuster.

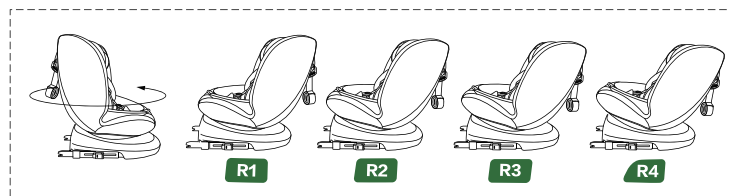

3.8 TOP TETHER ADJUSTMENT

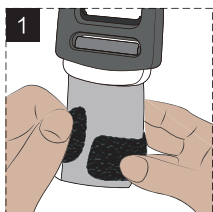
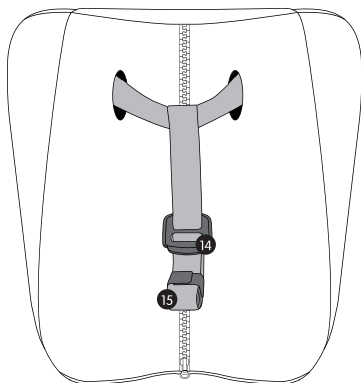

• Firstly, tear the storage Velcro (see 1);

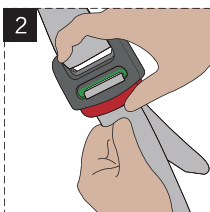



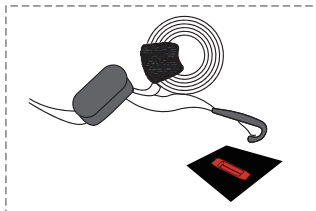
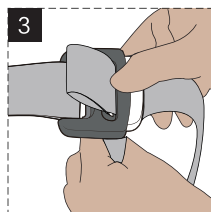







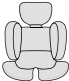
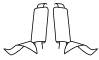







• Secondly, press and hold the button of the top tether adjuster (see 2) and release the top tether to the appropriate length (see 3);



• Thirdly, hang the top tether connector to the top tether anchorage which recommended in the vehicle user manual;

• Finally, tighten the top tether until the adjustment indicator shows green.

NOTICE BEFORE INSTALLATION

	 Small Headrest+Cushion	 Shoulder pads / Shoulder straps	 Crotch pad	 Buckle
 40-87CM				
 87-105CM				
 100-150CM				

4.1 REARWARD-FACING INSTALLATION



Usage : ISOFIX+Top tether
Height: 40–105cm

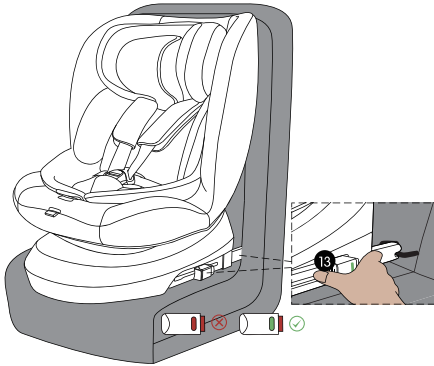

Step 1:

Extend the ISOFIX attachments on both sides and clip into the ISOFIX anchor points in the car until you hear a "click" sound. Make sure that the ISOFIX indicator turns to GREEN. 

Then, push the child seat until it is tight against the car seat.

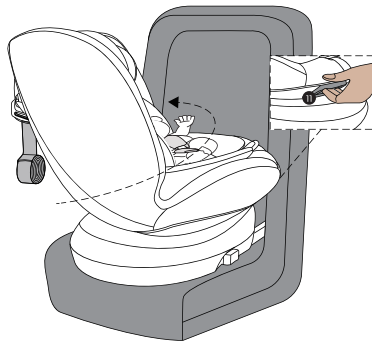

Step 2:

Press the rotation adjuster and turn the child seat to rearward facing position. When you hear a "click" sound, that means it is locked.

Pay attention!!

Do not drive when the safety seat is positioned at a 90° angle.

4.1 REARWARD-FACING INSTALLATION

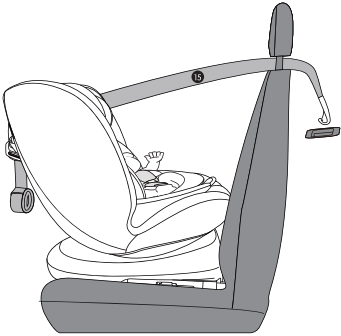

Step 3:

Extend the top tether strap to a suitable length, and then clip the top tether connector to the top tether anchorage of the car seat.

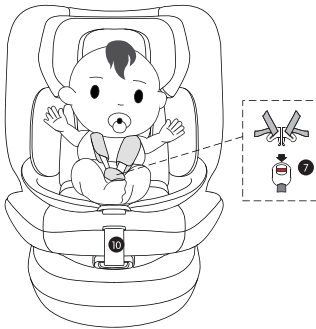

Step 4:

Place the child on the child seat and insert the buckle into the buckle slot until you hear a "click" sound. Then, tighten the harness by pulling the harness adjuster strap.

*The harness should be adjusted as tightly as possible without causing discomfort to your child. A loose harness can be dangerous.

*Check the harness adjuster and tighten each time when the child is placed in the seat.

4.2 FORWARD-FACING INSTALLATION



Usage : ISOFIX+Top tether

Height: 76-105cm

*76-105cm, please remove the headrest padding + cushion padding

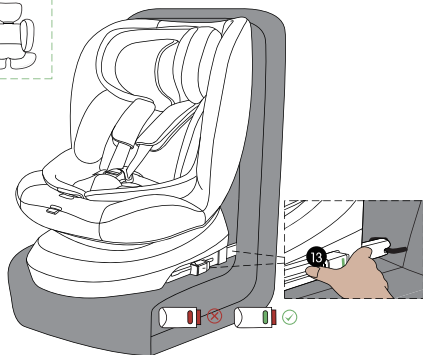

Step 1:

Extend the ISOFIX attachments on both sides and clip into the ISOFIX anchor points in the car until you hear a "click" sound.

Make sure that the ISOFIX indicator turns to GREEN.

Then, push the child seat until it is tight against the car seat.



Step 2:

Extend the top tether strap to a suitable length, and then clip the top tether connector to the top tether anchorage of the car seat.

4.2 FORWARD-FACING INSTALLATION

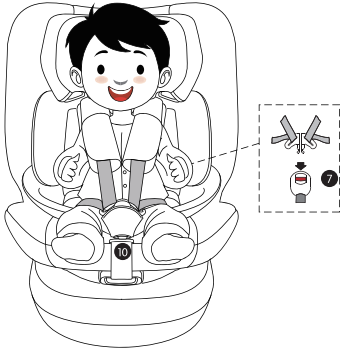

Step 3:

Place the child on the child seat and insert the buckle into the buckle slot until you hear a "click" sound. Then, tighten the harness by pulling the harness adjuster strap.

*The harness should be adjusted as tightly as possible without causing discomfort to your child. A loose harness can be dangerous.

*The crotch strap should be as low as possible and should be located close to the crotch, not the abdomen.

*To ensure the comfort of your child, the safety belt must not be twisted.

4.3 FORWARD-FACING INSTALLATION



OPTION 1

Usage : ISOFIX + 3 point belt

Height: 100–150cm

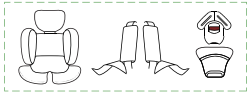

***100-150cm. please remove the cushion padding, crotch pad, buckle, shoulder pad and the shoulder straps.**



Extend the ISOFIX attachments on both sides and clip into the ISOFIX anchor points in the car until you hear a “click” sound. Make sure that the ISOFIX indicator turns to GREEN.

Then, push the child seat until it is tight against the car seat.

Place the child on the child seat and adjust the headrest according to the child's height.

Pull out the 3 point seat belt then pass through the shoulder belt guide of the headrest and the lap belt must pass through the lap belt guidings. Finally, you can buckle it.

4.3 INSTALLED FORWARD-FACING



OPTION 2

Usage : Only 3 point belt

Height: 100–150cm

■ Shoulder belt ■ Lap belt



Place the child on the child seat and adjust the headrest according to the child's height.

Pull out the 3 point seat belt then pass through the shoulder belt guide of the headrest and the lap belt must pass through the lap belt guidings. Finally, you can buckle it.



*When using the child seat, it should be confirmed that the buckle of the adult 3-point belt does not interfere with the main load-bearing contact point of the child restraint system. If there is any doubt, please contact the manufacturer of the child restraint system.

5.1 DAILY MAINTENANCE

- During regular use, periodically check the child seat. Replace the child seat after an accident to ensure safety.
- Store the child seat in a dry and ventilated place to prevent dampness and mold.
- If the child seat becomes dusty, clean the seat belt and plastic pieces by wiping them with a damp sponge. Let them dry in ambient air.
- In case food or drink accidentally spills on the buckle, disassemble the seat belt from the child seat and gently rinse it with warm water. Allow it to dry in ambient air.
- For cleaning the entire child seat fabric cover, please refer to section 5.2 for washing instructions

5.2 WASHING INSTRUCTION

*Never use any solvent, chemical detergent or lubricant on any part of your child seat.



Hand wash, water
temperature
below 30 °C



Do not bleach



Dry clean, any
solvent except
trichloroethylene.



Do not tumble dry



Do not iron

5.3 REMOVE AND ASSEMBLE THE FABRIC COVER

Disassembly step

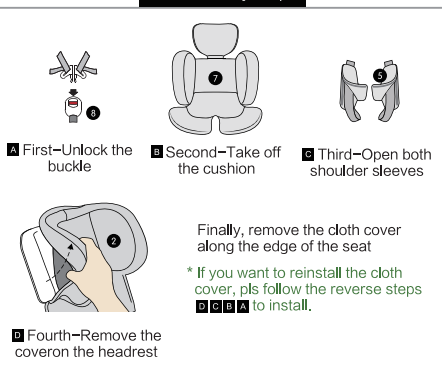
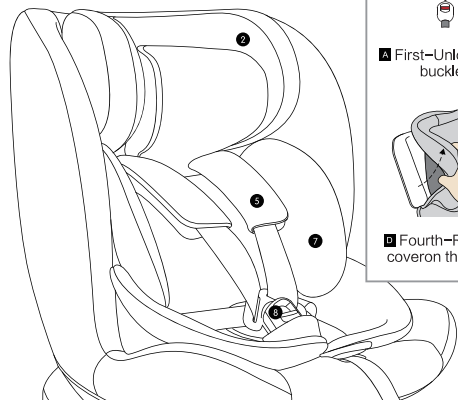

600MM



440MM

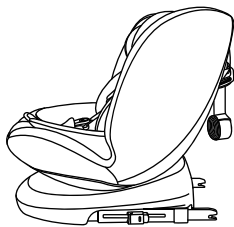

535MM

- Distance from front to back of the seat:535mm
- Distance form left to right of the seat:440mm
- Height of the seat:600mm